

Cleats & Cable Fixings



Description



Features & Benefits



FP Firefix™ Single Clip

- > The FP FIREFIX™ system is a joint venture between Prysmian, market leaders in fire resistant cables and ITW Construction Products, manufacturers of SPIT PULSA™ gas nailing technology.
- > It's fast, it's easy and it meets the cable support requirements of the British Standard: BS5839-1:2002
- > The system utilises gas nailing technology to install fire performance cables directly to a substrate. Unlike conventional clipping methods, this is an extremely fast and easy way to fix FP200 Gold® cable whilst offering significant installation cost savings.
- > The FP FIREFIX™ single cable clip is a new fixing for FP200 Gold® cables.
- > It is an alternative to "P" clips and allows the fixings to be installed prior to the cable, reducing the need for an electrician at this stage of fixing.
- > The single cable clip is an addition to the popular FP FIREFIX™ range and has been launched to install fire alarm systems that incorporate single cables.

- > Securely holds one FP cable - Ideal for single cable runs
- > Compact, aesthetically pleasing design - Ideal for visible installations
- > Clip fits directly onto Pulsa™ 700E pin guide - No need for an adaptor
- > Can be installed prior to cabling - Reducing the need for an electrician at this stage of fixing
- > Corrosion resistant stainless steel with red or white coating
- > Easy to install - No need for drilling, plugging or screwing
- > Tool does NOT use an explosive charge - No explosive charge licence required
- > Speedy installation - Providing significant cost savings
- > Ideal for PFI jobs that usually have an installation and speed focus
- > Meets the cable support requirements of BS5839-1:2002 - Providing complete peace of mind
- > 10 year warranty offered on Prysmian FP cable system when installed using FP FIREFIX™

FP Firefix™ Single Clip

Contractors using the Pulsa™ system continue to report substantial installation time savings over their previous method of fastening. They have discovered that Pulsa™'s actual cost-in-place beats any other system. Don't just look at the cost of the nails and fuel, factor in the labour rate you use to bid for jobs and discover your actual savings using Pulsa™. The increased speed and productivity of Pulsa™ reduces the cost per installed fixing so contractors complete jobs sooner, bid more competitively and move on to the next job faster.



Clip Details

Installation

> The FP FIREFIX™ single clip is attached directly to the Pulsa™ 700E gas tool. The clip is securely fixed by a nail to the surface; be it steel, block work, composite steel decking, brick or concrete. The FP cable is then inserted and clip closed. It takes just 10 seconds to fix, making a huge saving in time and money.

1. Position the FP FIREFIX™ clip directly on to the nail guide
(No adaptors required)
2. Ensure the substrate is clear before pushing the Spit Pulsa™ tool against the substrate, and nailing the clip into position
3. Place the FP cable into the clip
4. Close clip

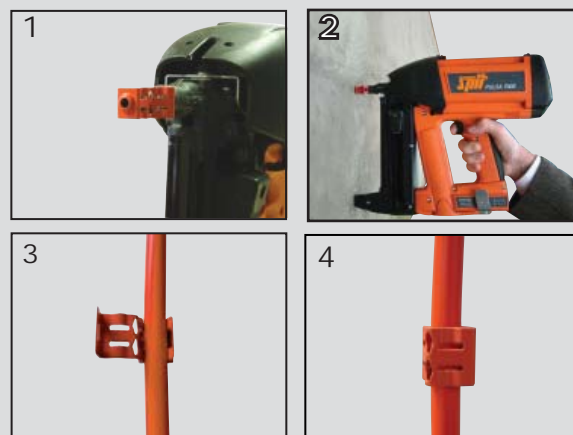

Note: Test fixings are always recommended, if in doubt please call the Pulsa™ technical hotline on 0800 298 0213

Kit Selection

- > Currently the single clip cable clip is only available for FP200 Gold® 2 core x 1.5mm² (Red or White)
 - > More clips sizes will follow shortly
 - > However single cables for other sizes of cable can currently be installed using the double cable clip (which takes either one or two cables).
- Please see selector charts opposite

Single Clip Selection (01)			
Cable	Size	Sheath Colour	FP FIREFIX™ kit ref.
FP200 Gold®	2 core x 1.5mm ²	Red	UFPNF01R
FP200 Gold®	2 core x 1.5mm ²	White	UFPNF01W

Standards

Meets the cable support requirements of BS5839-1:2002

Quality Assurance

Certified to ISO 9001

Other Products

- We also supply other accessories from the FP Range including:
- > FP FIREFIX™ double cable clip
 - > FP cable glands
- Details available on request

Single Clip Selection (01)	
FP FIREFIX™ kit ref.	Cable Diameter Suitability
UFPNF01R	8.0mm ² ≤ D < 8.2mm ²
UFPNF01W	8.0mm ² ≤ D < 8.2mm ²

NOTE: Pulsa™ 700E tool is sold separately